



# CULT INTERFACE MOTORCYCLES

## BMW R 12 G/S

### ASSEMBLY GUIDE | GPS MOUNT

#### **Tools Required**

- ☐ Ratchet + Extension
- ☐ 3mm Allen Socket
- ☐ 4mm Allen Socket
- ☐ 5mm Allen Socket
- ☐ 13mm Wrench / Spanner
- ☐ T25 Torx Socket
- ☐ Blue Loctite (recommended)

Number	QTY	Specifications	Torque (NM)
<u>1</u>	4	M8 x 20mm Tapered Allen Bolt	<b>23</b>
<u>2</u>	2	M6 x 16mm Allen Bolt	<b>10</b>
<u>3</u>	2	M5 x 30mm Allen Bolt	<b>6</b>
<u>4</u>	2	M5 x 16mm Allen Bolt	<b>6</b>
<u>5</u>	4	M8 Washer	-
<u>6</u>	4	M8 Nyloc Nut	-
<u>7</u>	2	M6 Washer	-
<u>8</u>	4	M5 Washer	-
<u>9</u>	2	12.50mm Spacer	-
<u>10</u>	4	OEM T25 Torx Bolt	*
<u>11</u>	2	Clip Nut	-

\* PLEASE REFER TO THE OWNER'S (OR SERVICE) MANUAL FOR **OEM** TORQUE SPECIFICATIONS.\*

**STEP 1 (Windshield Removal) :**

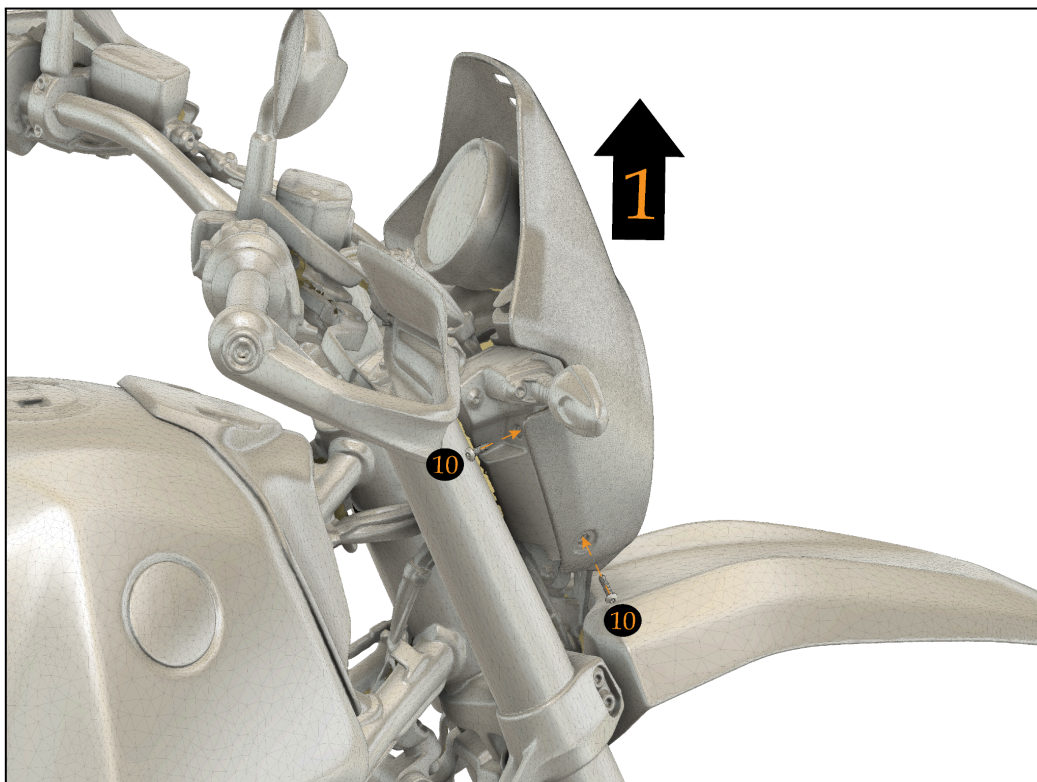

**STEP 2 (GPS Mount Assembly) :**

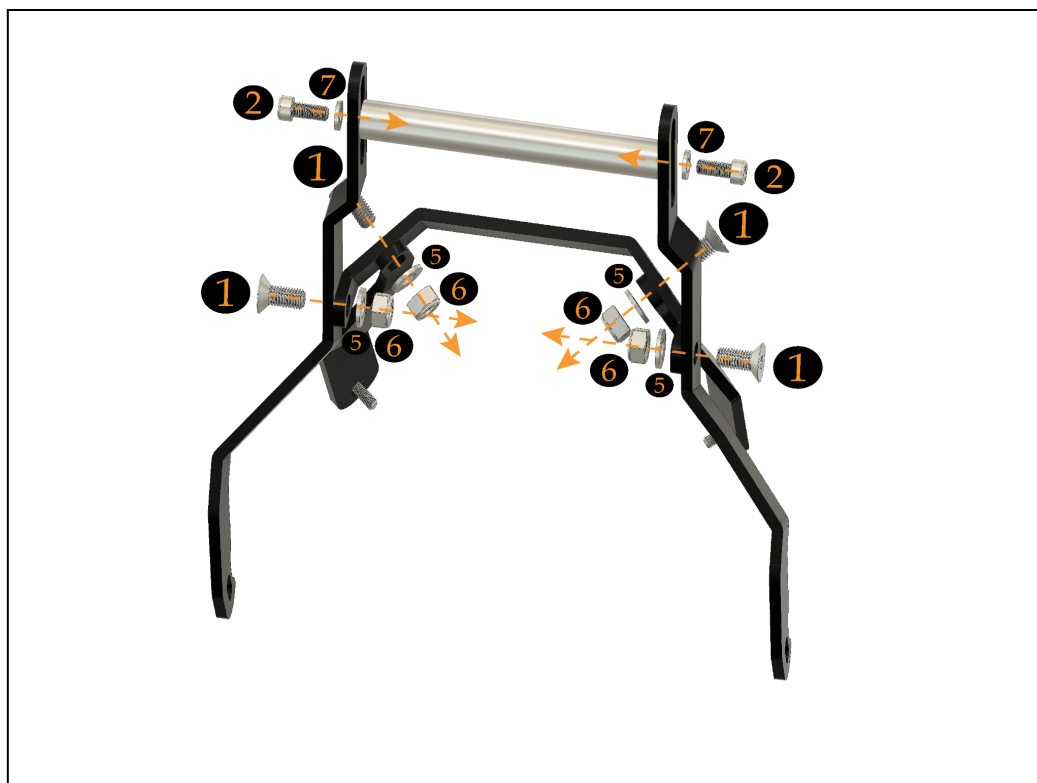

\* PLEASE REFER TO THE OWNER'S (OR SERVICE) MANUAL FOR OEM TORQUE SPECIFICATIONS.\*

### STEP 3 (GPS Mount Install) :

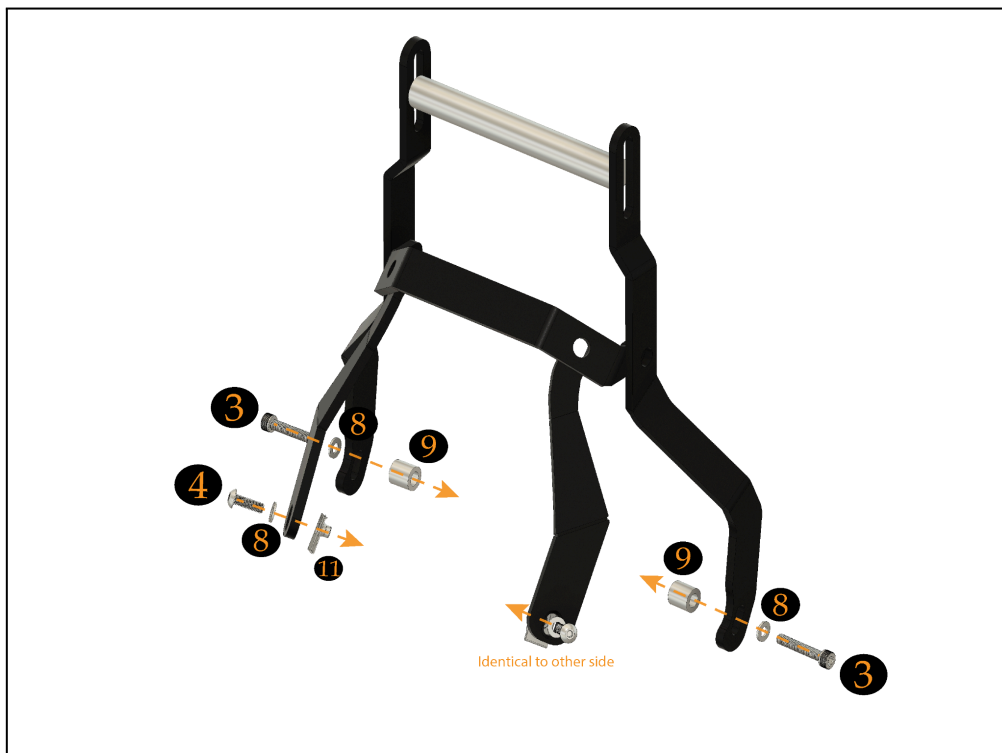

#### **\* Torque Disclaimer \***

Torque specs provided by Outback Motortek are for guidance only and may reference OEM data. Incorrect torque application from miscalibrated or improperly stored torque wrenches (which can drift by up to 20% within 12 months) may cause broken studs or mounting failures. Always return torque wrenches to 0 ft-lbs when storing, and use blue Loctite (medium strength) on all fasteners to help prevent loosening. Outback Motortek is not responsible for damage or failures caused by mis-torquing or improper installation.